

JEB
Partitions



DIVIDE



DIVIDE

The DIVIDE partition system by JEB has been developed with ease of relocation and flexibility in mind while maintaining a streamlined and contemporary look and feel. Panels come in an unlimited range of finishes which simply 'hook' on to the load bearing structure. This makes DIVIDE the perfect option for companies that have a high rate of churn.

DIVIDE rounds out JEB's partition offering to keep the company at the forefront of this competitive industry.

PARTITIONS

DOUBLE GLASS PARTITION

A flush glazed system gives a contemporary outlook

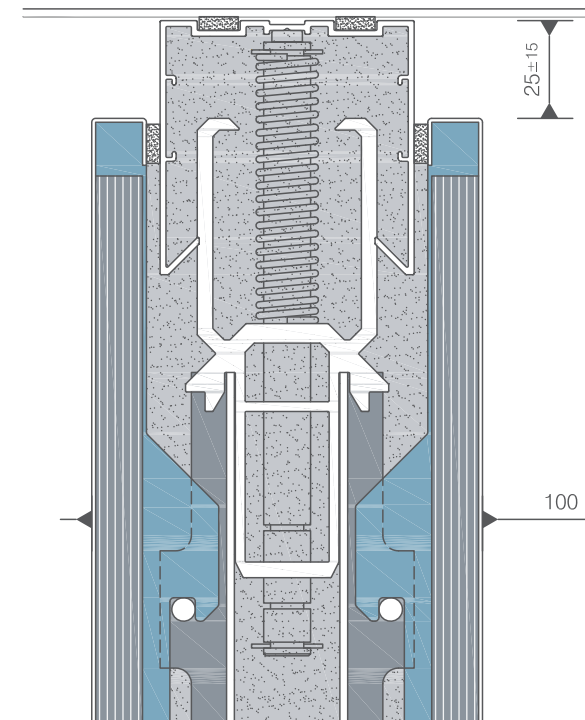
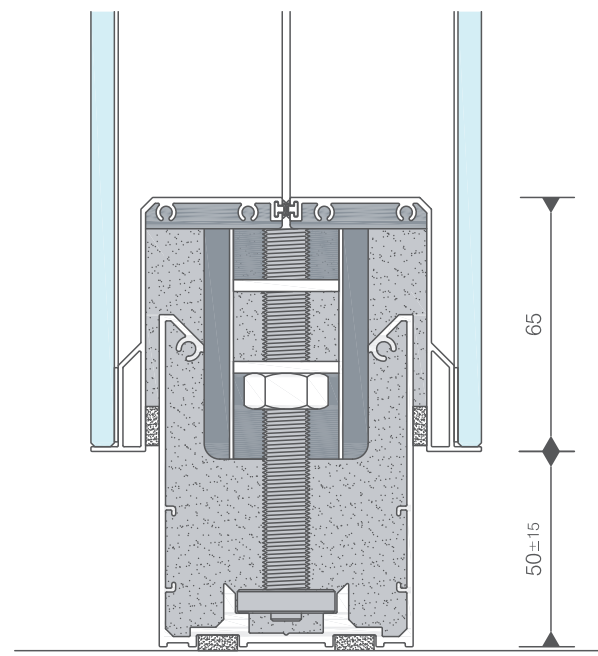
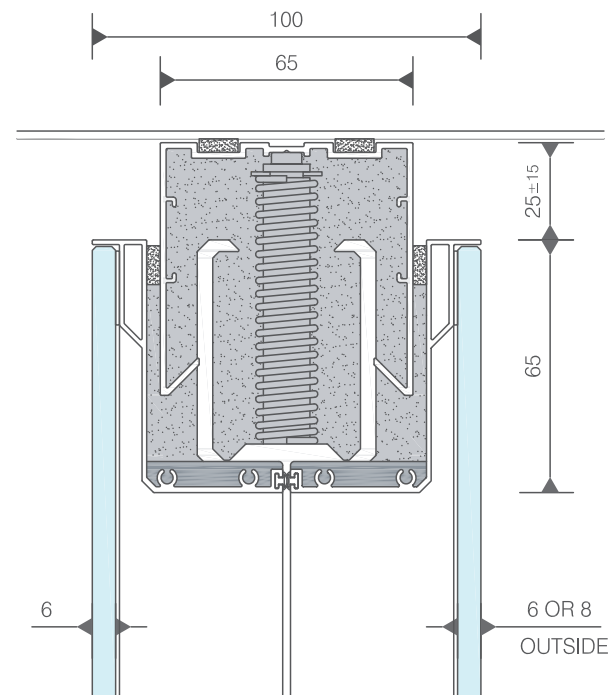

SOLID PARTITION

Metal finish as a standard which can be changed to other finishes by simply changing the panels

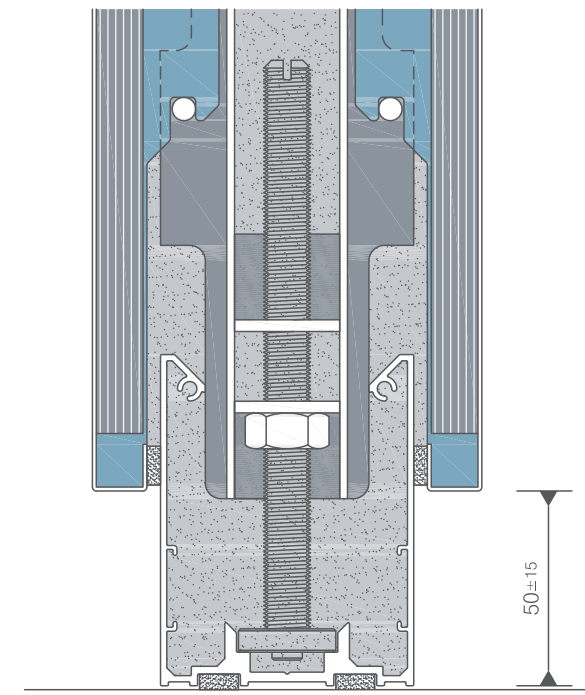



DESIGN FLEXIBILITY

The load bearing structure consisting of tracks and mullions provide for easy cladding whereby solid and glazed panels are interchangeable.

The panels simply hook on to the mullions which allows for any type of finish to be applied to the system including (but not limited to) metal, timber, fabric, stone and a huge range of glass from JEB Architectural Finishes. Inset or proud white boards can be accommodated easily as can acoustic panels.

DIVIDE provides a full range of doors including:

- Timber swing and sliding doors
- Frameless swing and sliding doors
- Double glass swing and sliding doors



RELOCATION FLEXIBILITY

DIVIDE is a bi-block demountable partition. Individual panels can be removed from either side without a double sided disturbance. Panels can be easily handled by one or two men. Any individual panels that may be damaged can easily be replaced without having to replace the whole module.

CABLE MANAGEMENT FLEXIBILITY

DIVIDE's load bearing structure provides a huge cable raceway allowing cable to be brought up from the raised floor or down from the ceiling almost anywhere within the partition. Panels can easily be opened for conduits and wiring that may be required for card readers, light switches, LCD screens etc. so that they can be mounted at a convenient place on the surface. Cabling can also be run inside the floor and ceiling track where glass modules are located.



ACOUSTICS & GLAZING

GLAZING OPTIONS

Flush glazing is available where glass panels are bonded onto the aluminium frames using structural tape. This feature provides a seamless glass appearance along corridors especially when used in conjunction with double glass doors. Minimal aluminium frames are also available, which provide a sleek appearance yet allow for glass with unpolished edges to be fitted which helps to save costs.

CUSTOMISATION

JEB's in-house design team can customise components to suit any given project.



HARDWARE

Hinges should be JEB proprietary offset pivot hinge, available for frameless doors or as heavy duty version for double glazed doors. The hinges come with standard mounting bracket to suit DORMA floor springs. Handles and lockset can be selected from JEB's standard range of hardware.

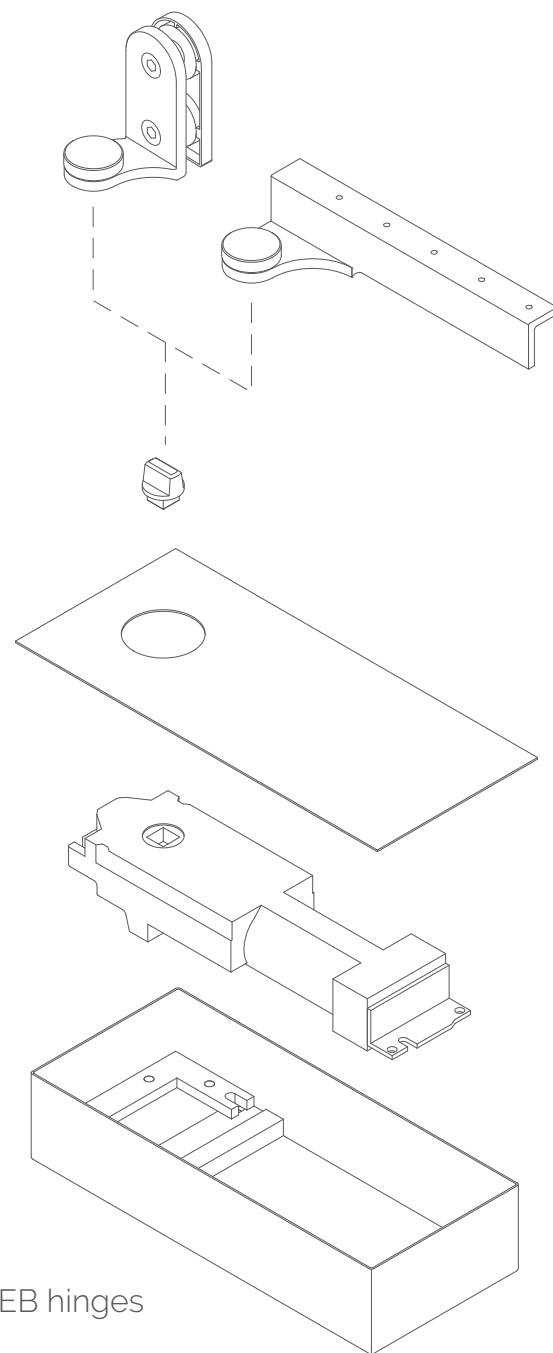

Concealed floor spring option for JEB hinges

STANDARD FINISHES

Anodising – matt natural, black and other options available on request

Powdercoating – according to design specifications

PVF2 – According to design specifications.

ACCESSORIES

Manual / electric Venetian Blinds

Custom Glass Designs

Custom screens in partition cavity

Switchable Glass

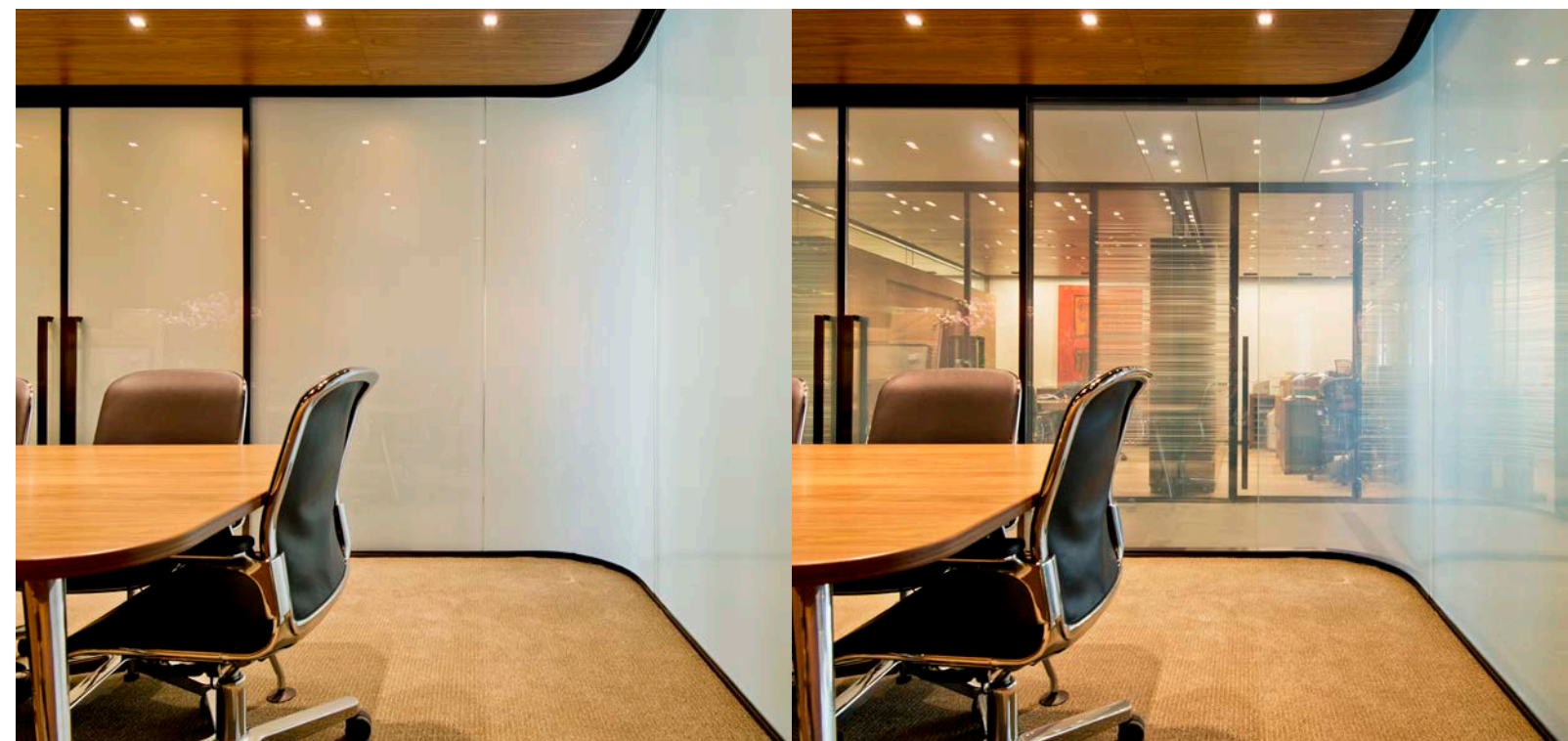



D/IDE

TECHNICAL DATA SHEET

Type Construction	Double Solid Panel	Double Glazed System
	Solid Panel - 49 dB	6+6mm Double Glazed Panel - 42 dB
Panel face / Finish - Sound insulation in STC		6+8mm Double Glazed Panel - 47 dB

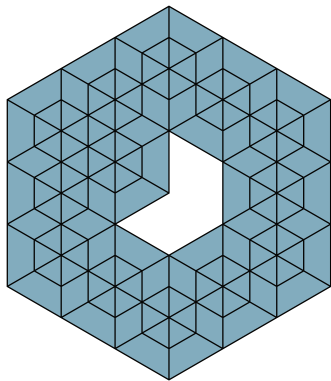

JEB
Partitions

www.jebpartitions.com

